

**CERTIFICATE No CF 291  
SCHOTT UK LIMITED**

**PYRAN S FIRE RESISTING GLASS**

**PYRAN S within Butt-Jointed Assemblies (Alternative Installation details) for periods of 30 minutes integrity**

6, 8, 10 and 12 mm thick PYRAN S may be used within butt-jointed assemblies up to maximum pane dimensions as detailed within Figure 20 and within the following installation specifications.

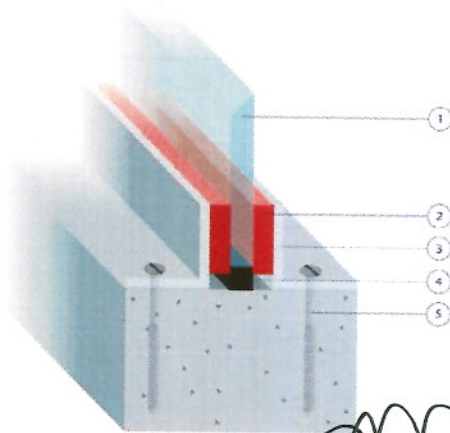

- 1 PYRAN S
- 2 20 mm by 6 mm ceramic fibre tape
- 3 25 mm by 25 mm by 3 mm thick mild steel angle
- 4 Non-combustible packer / setting block
- 5 Minimum 50 mm long steel screws fixings at 250 mm centres

**Back to Back Steel Angle Detail**  
*Angles painted Black*

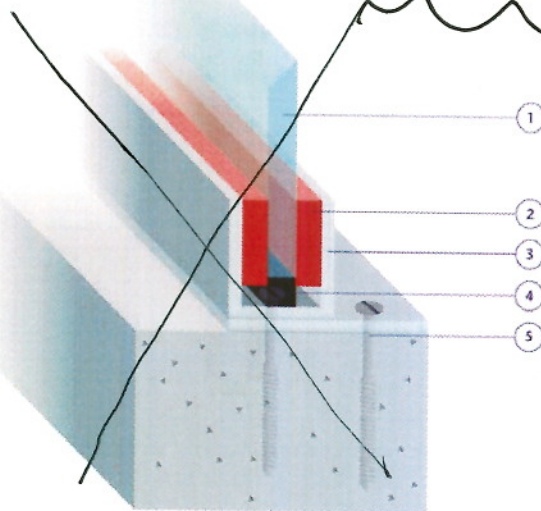

- 1 PYRAN S
- 2 20 mm by 6 mm ceramic fibre tape
- 3 Mild steel angle forming 30 mm deep glazing pocket
- 4 Non-combustible packer / setting block
- 5 Minimum 50 mm long steel screws fixings at 250 mm centres

~~Channel Detail~~

**REF: 1719 - TP-07**

*Paul Bygg*